

LUXURY LIVING IN 'City

Where Elegance Meets Comfort



PREMIUM RESIDENTIAL PLOTS

"Invest today and build tomorrow"

 **DESOM,**
Aluva, Ernakulam

“Presenting premium residential plots in a well planned layout with wide roads, greenery, and easy connectivity to the city. Perfect for building your dream home or as a future investment.”

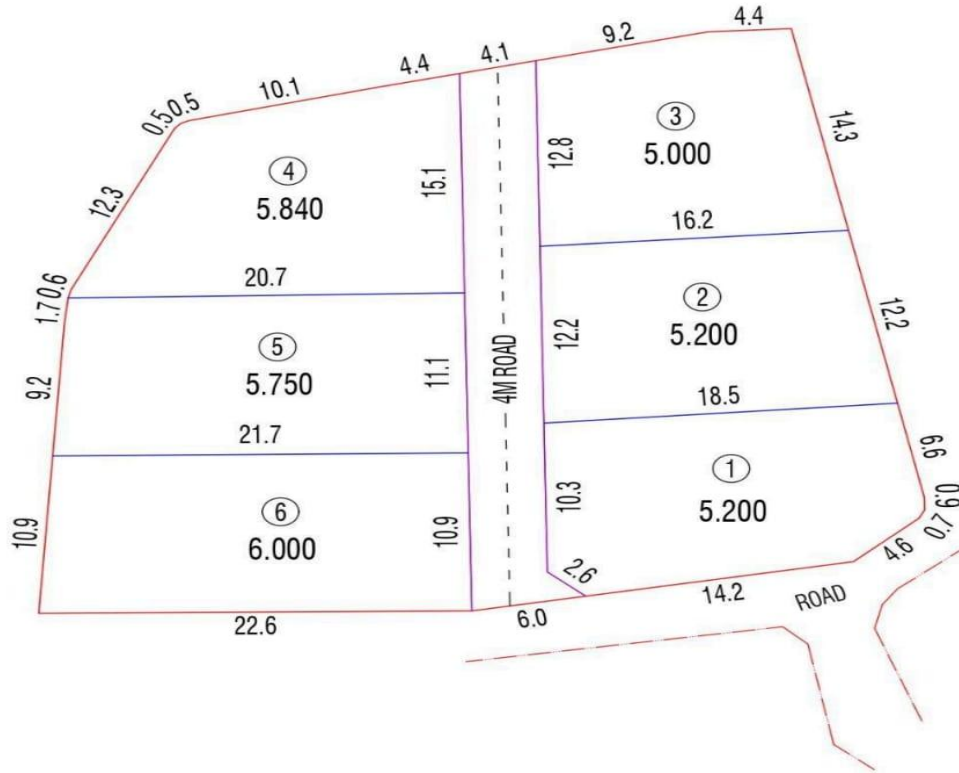

Investment Benefits



Only 5.6 km distance from “Cochin International Airport” which offers high investment potential due to excellent connectivity, rapid infrastructure growth, and rising demand for residential and commercial development.



Only 1 km from “National Highway” which ensures excellent accessibility, higher resale value, and strong potential for commercial and residential development.



Only 1.5 km from upcoming project proposed by KCA, which is the “country’s first Carbon- neutral sports city featuring international cricket stadium”. This opens excellent investment potential due to the expected rapid development, rising property demand, and future commercial opportunities.

Owning this land means securing a prime spot in a fast growing area with guaranteed future value and endless possibilities.

“WHY CHOOSE THIS PROJECT ?”

- Clear title and immediate registration
- Well planned layout with wide roads
- Ready to build plots
- Electricity and water availability
- Compound wall and tiled road
- Approved by local authorities







PRIME LOCATION

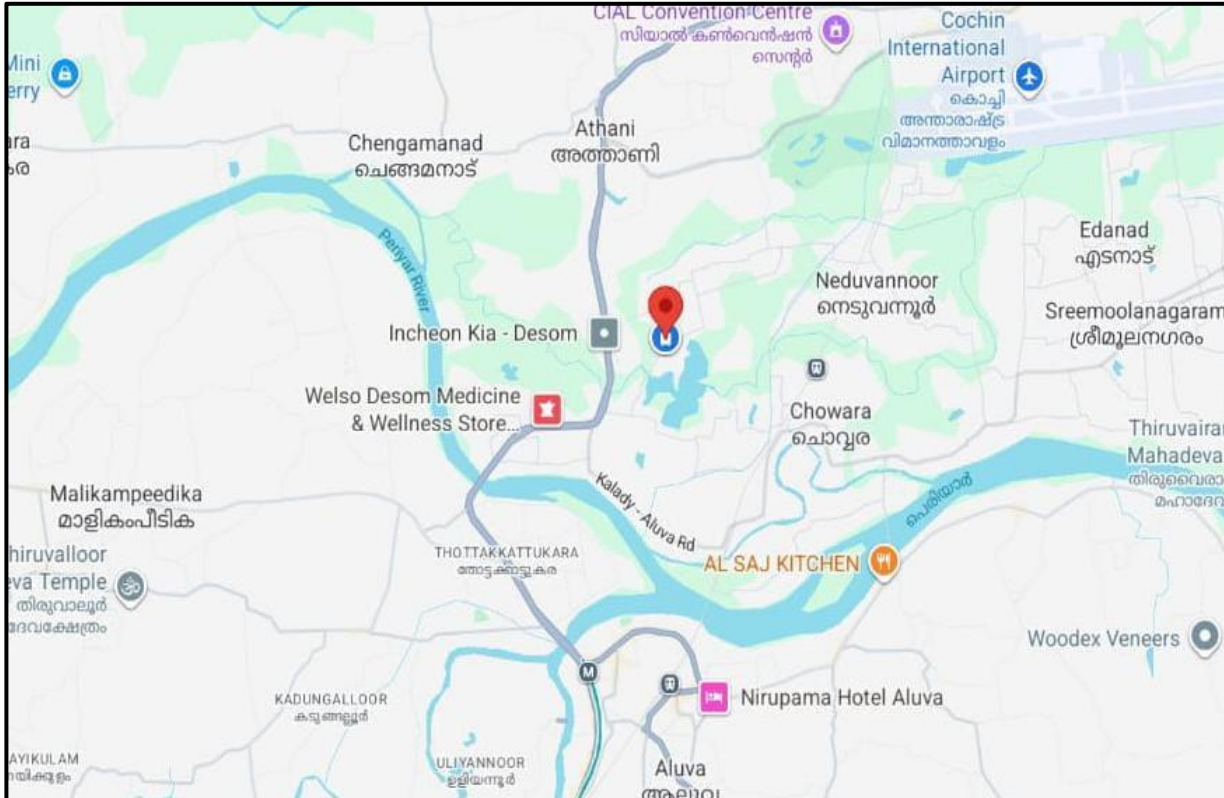



- Cochin international Airport: 5.6 km
- Aluva railway station: 7.8 km
- Angamali town : 9.9 km
- National Highway : 1 km
- Metro station : 6.8 km

- *Close to schools, hospitals, shopping centres*
- *Peaceful residential environment*

PRICING

4 Lacks/ cent

Connect with us:

- Grasshoper
3 rd floor, Trans square building, Mavelipuram, Kakkanad- 682030
-  7034 100 344
-  official@grasshoper.in
-  Instagram: @grasshoperofcl

“Book your site visit today”